



LAKES OF PARKWAY SECTION 17

1	13410
2	13410
3	13428
4	13428
5	13428
6	13428
7	13428
8	13428
9	13428
10	13428
11	13428
12	13428
13	13428
14	13428
15	13428
16	13428
17	13428
18	13428
19	13428
20	13428
21	13428
22	13428
23	13428
24	13428
25	13428
26	13428
27	13428
28	13428
29	13428
30	13428
31	13428
32	13428
33	13428
34	13428
35	13428

**LEGEND**

- SPEC
- SOLD
- RESERVED
- CLOSED

**LEGEND**

- TOWNHOMES
- 55' LOTS
- 60' LOTS
- 70' LOTS
- 80' LOTS
- 100' LOTS

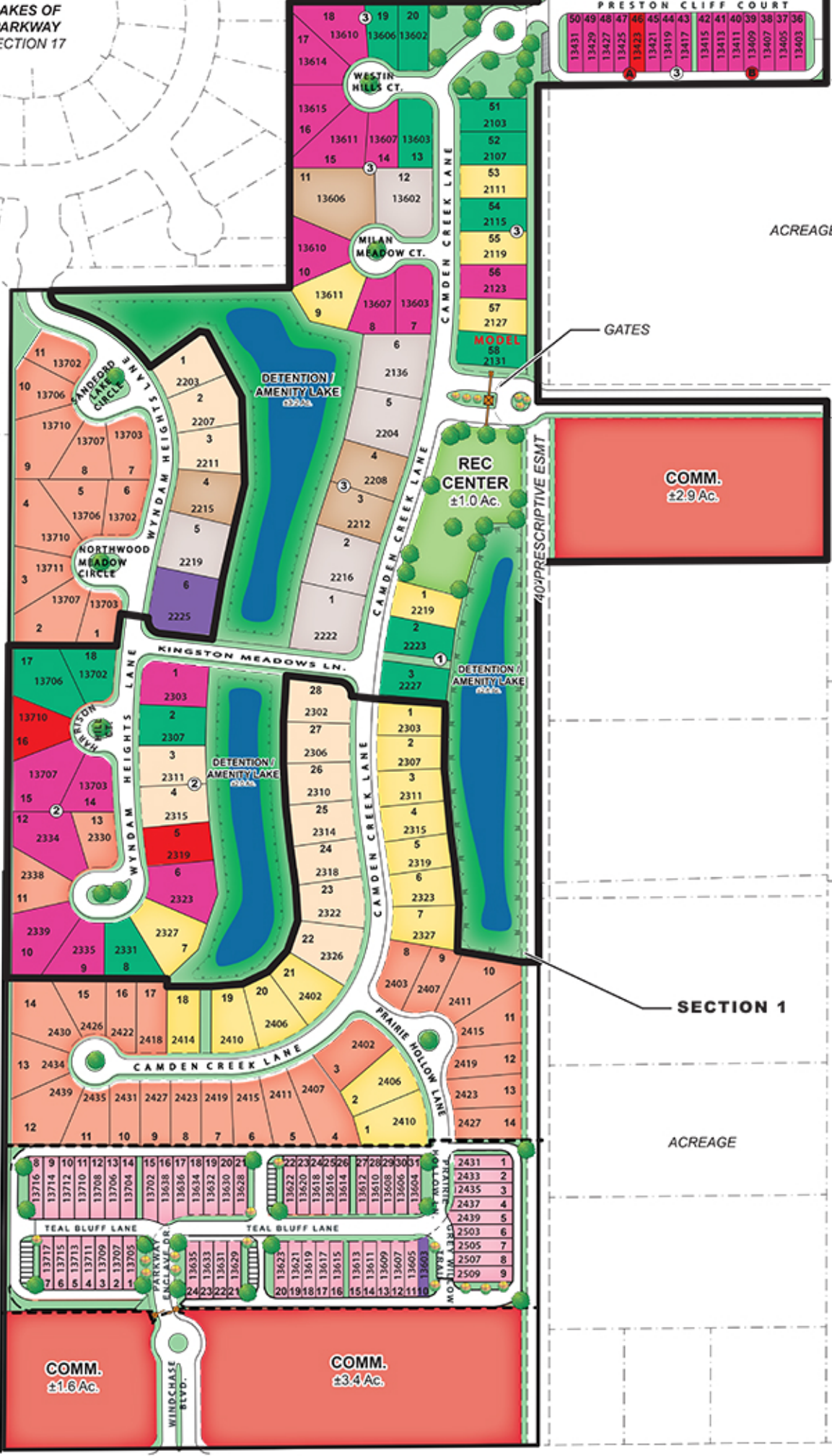

COMM. ±2.9 Ac.

COMM. ±1.6 Ac.

COMM. ±3.4 Ac.

BRIAR PARK

HOUSTON COMMUNITY COLLEGE

ELDRIDGE PKWY

WESTHEIMER RD

a lot exhibit for  
**THE PARKWAY**  
 ±58.2 ACRES OF LAND



KERRY R. GILBERT & ASSOCIATES, INC. Land Planning Consultants  
 23501 Cinco Ranch Blvd. Suite A-250  
 Katy, Texas 77494  
 (281) 579-0340  
 Fax (281) 579-8212

SCALE  
 0 50 100 150

DECEMBER 05, 2012  
 KGA #7007

THIS DRAWING IS A PICTORIAL REPRESENTATION FOR PRESENTATION PURPOSES ONLY AND IS SUBJECT TO CHANGE. FURTHER, SAID DRAWING IS A SCANNED IMAGE ONLY AND IS NOT FOR COMPUTATION OR CONSTRUCTION PURPOSES. THIS DRAWING MAY OR MAY NOT INCORPORATE INFORMATION AND/OR DATA PROVIDED TO KERRY R. GILBERT & ASSOCIATES, INC. BY OTHER CONSULTANTS RELATIVE TO ENGINEERING AND DRAINAGE, FLOOD PLAINS AND ENVIRONMENTAL ISSUES AND SHOULD NOT BE RELIED UPON FOR ANY PURPOSE. NO WARRANTIES, EXPRESS OR IMPLIED, CONCERNING THE ACTUAL DESIGN, LOCATION, AND CHARACTER OF THE FACILITIES SHOWN ON THIS MAP ARE INTENDED. ADDITIONALLY, NO WARRANTY IS MADE TO THE ACCURACY OF THE INFORMATION CONTAINED HEREIN.

©2012 KERRY R. GILBERT & ASSOCIATES, INC., ALL RIGHTS RESERVED

REV 6/24/2016